

T5 5" Touch On-Camera Monitor

- 1920x1080
- TOUCH
- HDMI2.0 4K 60Hz
- HDR 3D-LUT



Touch On-Camera Monitor with Full HD Resolution, excellent color space
Perfect gear on DSLR for taking photos & making movies.



4K 60Hz - HDMI 2.0

HDMI 2.0 supports 4096x2160 60p/50p/30p/25p and 3840x2160 60p/50p/30p/25p.

Some commercially DSLR(GH-5, R5...) have been upgraded to HDMI 4K 60Hz video output. It means this touch monitor is compatible with the best output video formats of DSLR on the market.

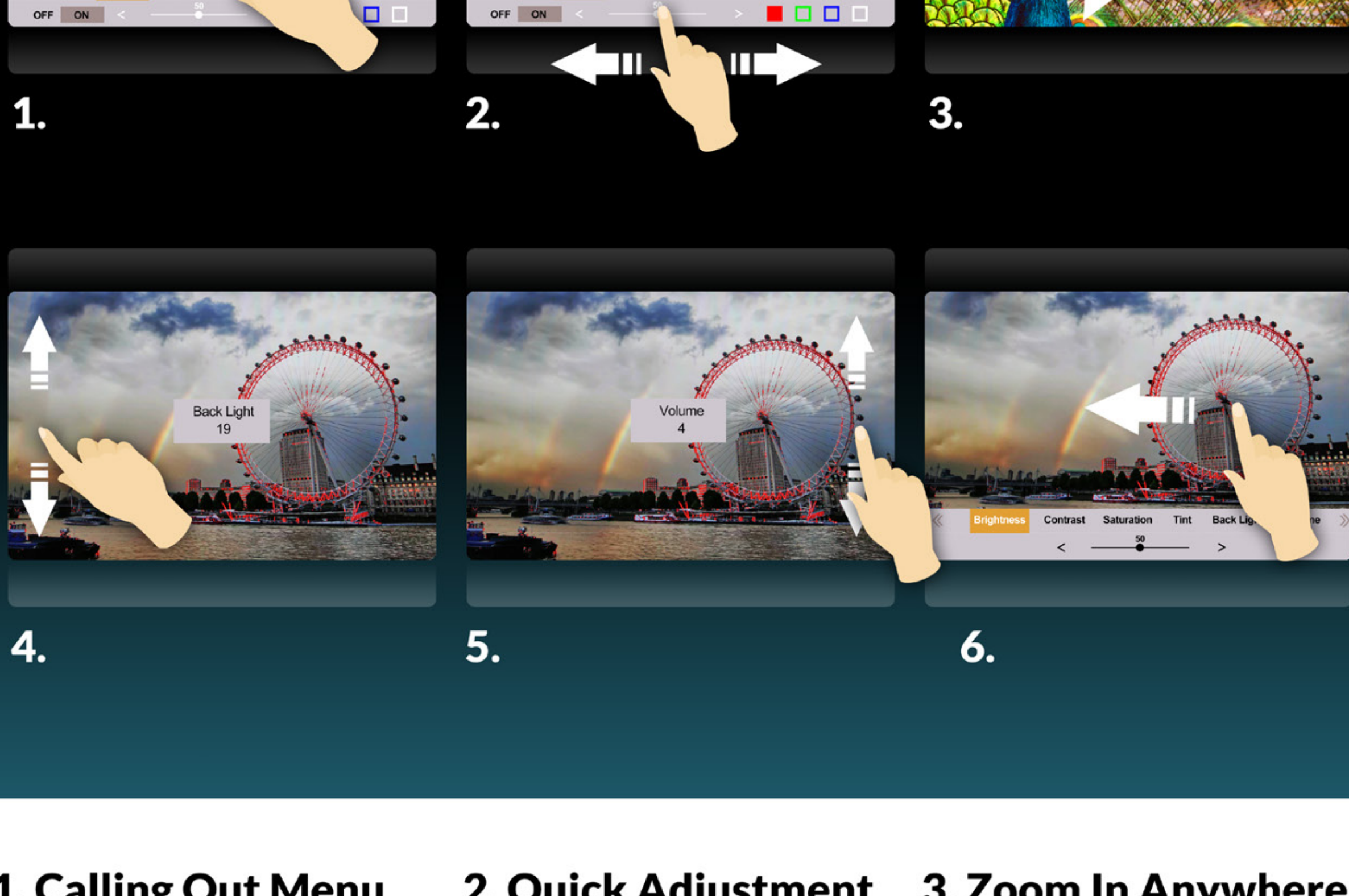

- 1. Calling Out Menu**
Swipe the screen left or right quickly will summon the menu. Then repeat action to close the menu.
- 2. Quick Adjustment**
Quickly select the function on or off from the menu, or slide freely to adjust the value.
- 3. Zoom In Anywhere**
Slide on the screen panel with two fingers anywhere to enlarge the image, and easy drag it to any position.
- 4. Back Light Control**
Swipe up and down on the left side of the screen to adjust the backlight.
- 5. Volume Control**
Swipe up and down on the right side of the screen to adjust the volume.
- 6. Display Menu**
Slide the screen left or right to quickly adjust the display parameters.



- Penetratingly Minute**
Creatively integrated the 1920x1080 native resolution (441ppi), 1000:1 contrast, and 400cd/m² into a 5 inch LCD panel, which is far beyond from retina identification.
- Excellent Color Space**
Cover 131% Rec.709 and 98% DCI-P3 color space, accurately reflect the original colors of an A+ level screen.

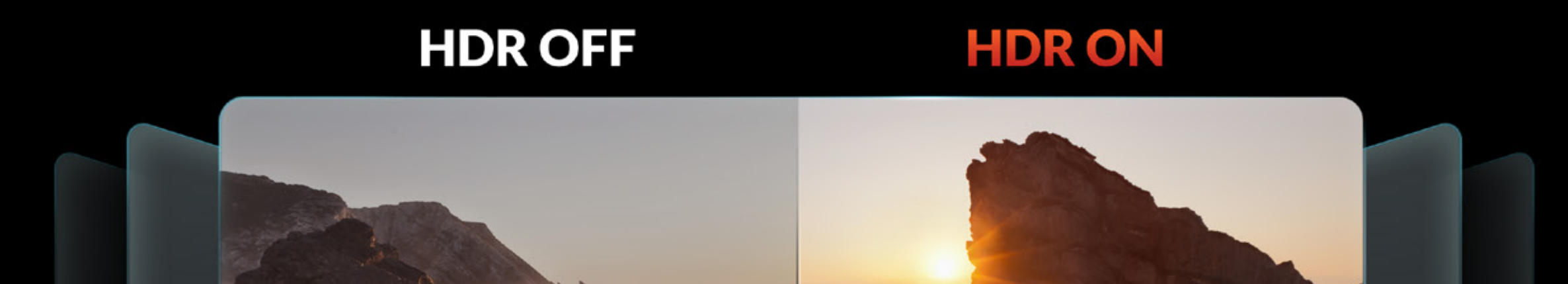

HDR

When HDR is activated, the display reproduces a greater dynamic range of luminosity, allowing lighter and darker details to be displayed more clearly. Effectively enhancing the overall picture quality. Support ST 2084 300 / ST 2084 1000 / ST2084 10000 / HLG.

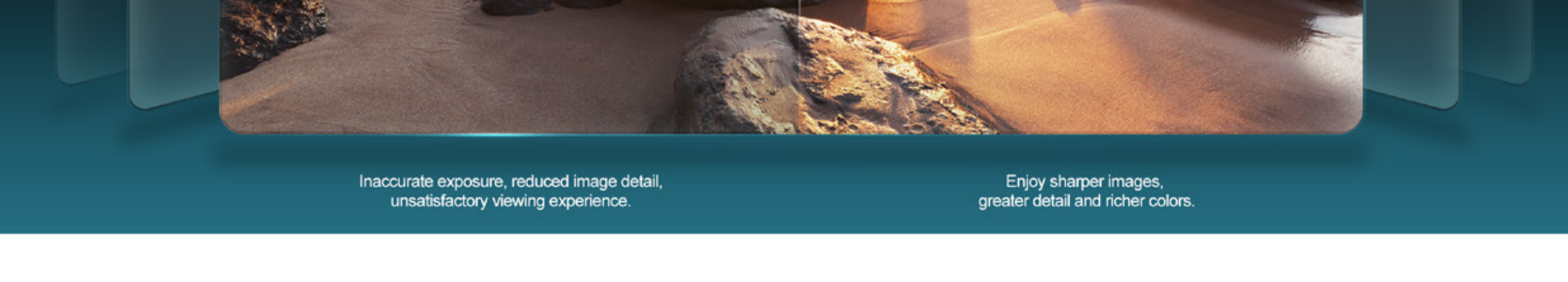

3D LUT

3D-LUT is a table for quickly looking up and output specific color data. By loading different 3D-LUT tables, it can quickly recombine color tone to form different color styles. Built-in 3D-LUT, featuring 17 default logs and 6 user logs.

3D LUT LOAD
Supports loading the cube file via USB flash disk.

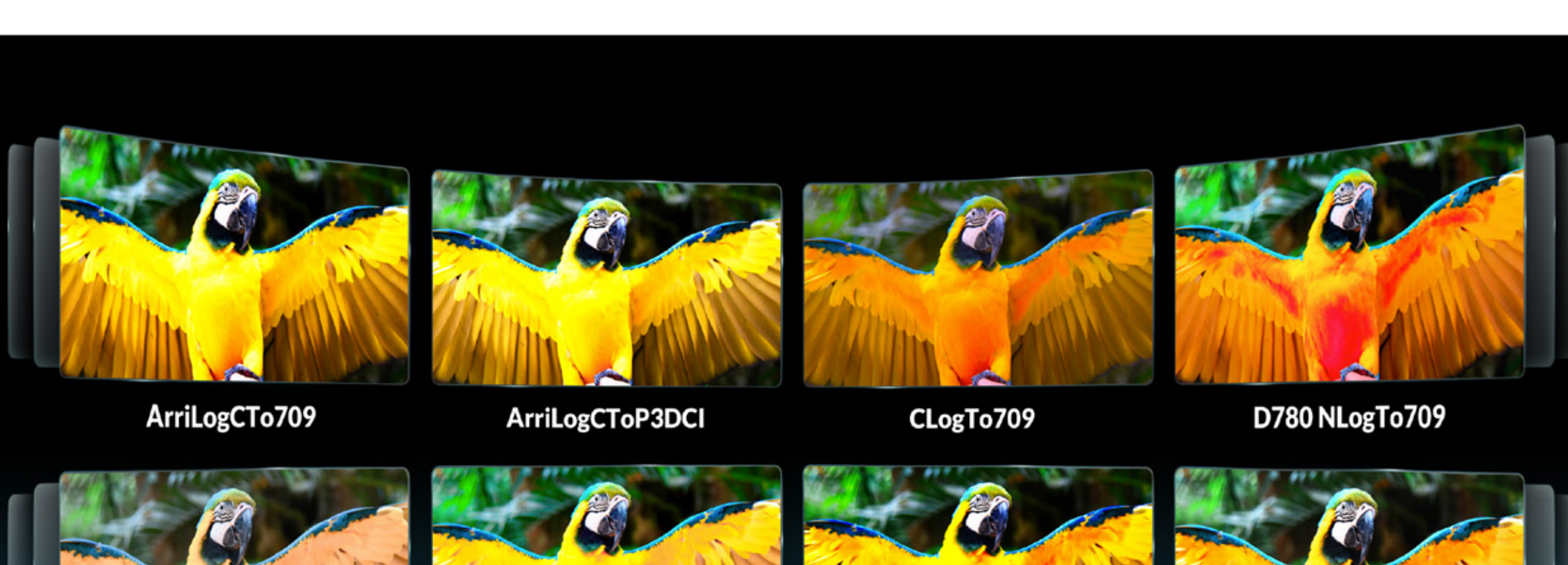

Camera Auxiliary Functions

Provides plenty of auxiliary functions for taking photos and making movies, such as peaking, false color and audio level meter.



Versatile Battery Structure

A dual battery mounting plate on the back is compatible with both Canon LP-E6 and Sony F-series batteries, and the DC 8V power output is also useful for unlimited purposes.

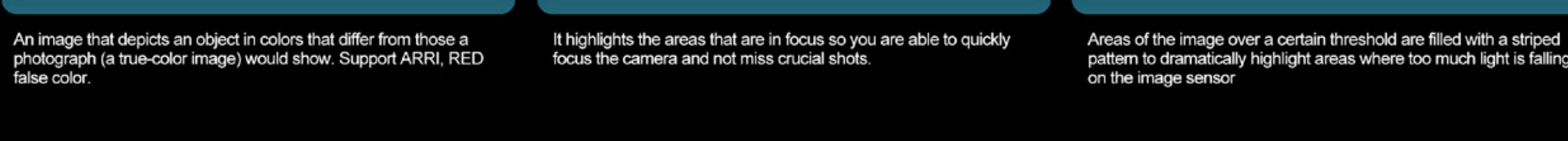

SPECIFICATIONS

DISPLAY	Panel: 5" IPS Touch Screen: Capacitive Physical Resolution: 1920x1080 Aspect Ratio: 16:9 Brightness: 400cd/m ² Contrast: 1000:1 Viewing Angle: 170°/ 170°(H/V) Supported Log Formats: ST 2084 300/1000/10000 / HLG, SLog2 / SLog3, ArriLog, Clog, JLog, VLog, Nlog or User...
VIDEO INPUT SUPPORTED FORMATS	LUT support: 3D LUT (cube format) HDMI: 1xHDMI2.0 HDMI: 2160p 24/25/30/50/60, 1080p 24/25/30/50/60, 1080i 50/60, 720p 50/60...
AUDIO IN/OUT (48kHz PCM Audio)	8ch 24-bit
POWER	Input Voltage: DC 7-24V Power Consumption: ≤5W / ≤17W (DC 8V power output in operation) Compatible Batteries: Canon LP-E6 & Sony F-series DC 8V
ENVIRONMENT	Operating Temperature: 0°C-50°C Storage Temperature: -10°C-60°C
OTHER	Dimension(LWD): 132x86x18.5mm Weight: 200g

ACCESSORIES

